

Datasheet

→ **QXL5DG** 

10/31/2024



Technical Data

Pilot light with Faston terminals
2.8x0.8 mm

<i>Series</i>	QUARTRON®
<i>Rubric</i>	Light attachment/indicator lights
<i>Shape</i>	square



→ General Data

<i>Illumination</i>	Yes
<i>Protection class</i>	IP65
<i>Mounting aperture</i>	Ø 16.2 mm
<i>Installation depth</i>	15.45 mm
<i>Front frame color</i>	anthracite
<i>Connection</i>	Flat plug 2.8x0.8 mm

→ Electrical Data

<i>Light source</i>	T5,5K Lamp socket
---------------------	-------------------

Technical Drawings

→ Dimensional drawing

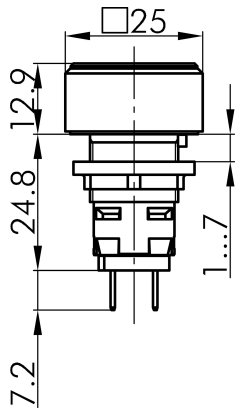

→ Cutout dimensions

