

# Datasheet

→ **QXJL5** 

10/31/2024



## Technical Data

Pilot light with Faston terminals 2.8x0.8 mm

<i>Series</i>	QUARTRON-JUWEL®
<i>Rubric</i>	Light attachment/indicator lights
<i>Shape</i>	square



## → General Data

<i>Illumination</i>	Yes
<i>Protection class</i>	IP65
<i>Mounting aperture</i>	24 x 24 mm
<i>Front frame color</i>	black
<i>Connection</i>	Flat plug 2.8x0.8 mm

## → Electrical Data

<i>Light source</i>	T5,5K Lamp socket
---------------------	-------------------

## Technical Drawings

→ Dimensional drawing

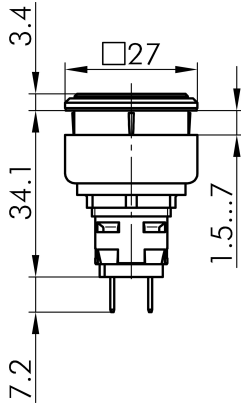

→ Cutout dimensions

