

KRJM_2USB_A_5V

20.06.2023



General Data

Type reference:	KRJM_2USB_A_5V
Description:	Double USB charger 24V/5V 2x 2.4A
Approvals:	CE, UKCA
Degree of protection:	IP20 (in the front); IP10 (on the rear)
Connection type:	rear: spring-load terminal 0.2 - 2.5 mm ² front: 2x USB jack type A
Max. storage temperature:	-40°C ... 80°C
Max. operating temperature:	-40°C ... 70°C *1)
Mechanical life:	5,000 mating cycles
Material:	PA

Technical data

Operational voltage:	15 - 31.2 V DC
Output voltage:	4.75 - 5.25 V DC
Max. output current:	2x 2.4 A *1)

General data

Mounting aperture:	30.5mm
Stripping length:	10 mm
Panel thickness:	2.0...12.0 mm
Mounting depth:	70.5 mm
Tightening torque (mounting nut):	1.5 ... 2.2 Nm
Weight:	approx. 28 g

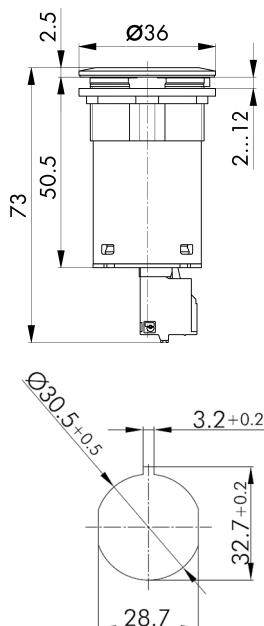

Note

For charging USB devices in industrial sectors and in public transport

Standards: EN 50155*, EN 61373 class 1B*, EN 60077-1, -2*, EN 45545-2*, EN 60068-2*, EN-50121-3-2*, IEC 61000-6-3/4*, EBA EMV06*; (* relevant parts)

Attention:

The maximum available power depends on the installation situation, the ambient temperature and the quality of the USB charging cable being used. The charging jack has cooling slots allowing a convection. They must be aligned vertically to ensure optimal performance.

Protection features:

- current limitation of the output current of each USB port with short-circuit, undervoltage and overvoltage protection
- thermal overload protection (deactivation of the outputs with automatic restart when reaching an uncritical working temperature)

Temperature monitoring on the USB jack:

If installed in places without air circulation and charging with cables that are not specified for the maximum possible currents, high temperatures can occur at the USB jack. To protect the user, this is continuously thermally monitored. If the temperature becomes too high, the charging process will be interrupted until the temperature falls below a non-critical level. The restart is done automatically.

* 1) see switch-off temperatures in the diagram on page 2.

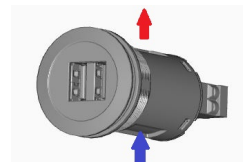

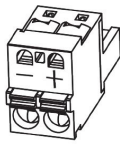

Assignment spring terminal (included in delivery):

(+): UIN+ = 15 - 31,2V
 (-): UIN- = 0V (GND)
 Cable cross section AWG min/max: 30 AWG / 12 AWG
 Cable cross section rigid/flexible min/max.: 0.2 mm² / 2.5 mm²
 Tool:
 Screwdriver 3.5 x 0.5 mm

CAUTION: Risk of injury if operating personnel is insufficiently qualified! Improper handling by unqualified or insufficiently qualified personnel can result to injury of persons or damages of property. Work requiring prescribed special measures should only be carried out by trained personnel or skilled workers, in particular by qualified electricians.

WARNING: Short circuits and electric shocks in case of incorrect application of voltage! Impact currents can injure people and destroy the device. Disconnect the entire systems from the mains prior to commissioning and check the connections upon applying the voltage.

NOTE:

- Respect the ESD regulations.
- Use only certified components. This is the only way to ensure a reliable function of the device.
- Observe the applicable safety and accident prevention regulations as well as the general rules of technology during set-up and operation.

Data Sheet (Art. 615400801)

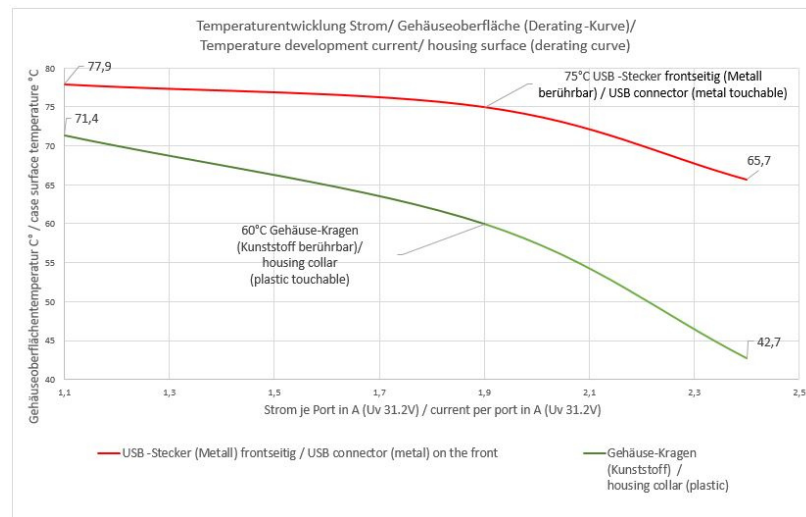
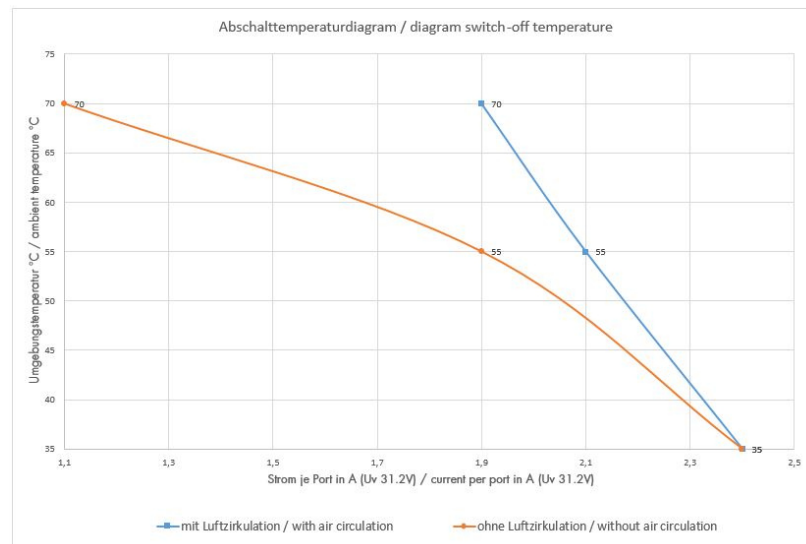

Gehäusetemperaturen in Abhängigkeit zur Umgebungstemperatur und Lastsituation (siehe Diagramm Abschalttemperaturdiagramm)
 Housing temperatures depending on the ambient temperature and load situation (please refer diagram switch-off temperature)